

# GUEST DIRECTORY



FOR EXECUTIVE EDUCATION

# WELCOME

We hope you enjoy your stay at  
the Fluno Center  
for Executive Education.

If you have any requests we may  
assist with to make your stay more  
comfortable, please contact the  
Front Desk by dialing 0 or using  
the direct dial button for the front  
desk on your phone.

## WELCOME

And thank you for choosing the Fluno Center for Executive Education for your stay in Madison. We know you have a lot of choices and we are confident we will not only meet, but exceed your expectations.

Should you need anything during your stay with us, please reach out to any of our staff. We will assist you in any way we can. I am also available to assist you as needed.

Again, thank you for choosing the Fluno Center for Executive Education and on behalf of my entire staff, enjoy your stay with us.

Sincerely,

Andy Abelman

608-441-7120--Direct

# INDEX

About the Fluno Center for Executive Education  
Check Out  
Hours & Telephone Directory  
Telephone Instructions  
Guest Conveniences  
Transportation  
Floor Plans & Maps  
Emergency Procedures  
Safety Tips  
Medical Services & Nearby Drugstores  
Sports & Recreation  
Places of Worship  
Restaurant Dining  
Delivery Dining , Nearby ATMs, Mall, and Movie Theatre Options  
Hair Salon Options  
Sustainability Information

For University of Wisconsin-Madison and city of Madison attractions, shopping, and other entertainment, please see the Visitor Guide and Map by the University of Wisconsin-Madison and the Madison & Vicinity Visitors Guide by Madison Magazine (location).

## **ABOUT THE FLUNO CENTER FOR EXECUTIVE EDUCATION**

The Fluno Center is a **total-immersion learning environment** for individuals, professional groups, and corporate teams participating in UW educational programs. Our collaborative classroom technology is combined with the ambiance of a comfortable, relaxed residential setting to establish an ideal venue for introspection, innovation, and focused learning

**Among the many types of events we can host for your organization are:**

- Half-day to multi-day conferences
- On-site catered networking receptions
- Buffet and plated dining experiences
- Convenient, on-campus recruitment events
- Private board and other meetings
- Custom learning solutions provided by Wisconsin School of Business Center for Professional and Executive Development

Our 100 well-appointed guest rooms are not only open to attendees here for any of the above mentioned meetings and events, but for those individuals that are:

- Alumni of UW Madison
- Individuals sponsored by a UW Madison Alum
- Family Members of past, present, or future UW Madison students
- WAA Members
- UW Madison visitors

### **A Gateway to the University**

Building on the UW-Madison tradition of excellence in academics and research, the Fluno Center serves as a gateway to the university. The Center connects the University's vast resources to the professional community. Every year, thousands of professional from industry, government, and nonprofit organizations participate in continuing education programs taught by the University's diverse, world-class faculty.

### **Designed for Education**

The Fluno Center for Executive Education creates a total-immersion learning environment for individuals, professional groups, and corporate teams to learn, exchange ideas, and explore. Away from everyday distractions, the focus is on learning. Participants have the opportunity to experience top-quality education, network with peers, and hold business meetings all in the same facility. Designed exclusively as an education learning facility, the Center provides the ideal location for UW Madison public enrollment programs and custom programs, including company and industry specific symposiums, seminars, and conferences.

## **Composed of Multiple Unique Spaces**

The Fluno Center for Executive Education combines collaborative classroom technology with the ambiance of a comfortable, relaxed residential setting. The building houses four classrooms, eight break-out rooms, the Mendota Room, 100 overnight guestrooms, the Howard Auditorium, Oros Executive Dining Room, fitness center, business center, and Smitty's Study Pub.

## **For Comfort and Harmony**

The Center's interior reflects the design principles of Frank Lloyd Wright. A lifelong learner and innovative designer, Wright was dedicated to creating total living and learning environments. The simplicity and harmony of the furnishings help create an atmosphere focused on creative, collaborative learning.

The natural elegance of the Arts and Crafts era harmonizes with Wright's design principles and is evidenced throughout the Fluno Center by quality craftsmanship and a décor that combines prairie style furnishings and original lithographs of designs by Frank Lloyd Wright himself.

## **Associations and Awards**

The Fluno Center for Executive Education is a member of the International Association of Conference Centers, a select group of conference providers with the highest standards in customer service, conference planning, building management, and sustainability. The Center is also a Gold Tier leader in IACC's Green Star Program for environmental responsibility. Conference centers must meet stringent criteria to earn and retain standing in the Green Star program.

The Center ranks in the top three for best conference centers in Wisconsin as measured by *Corporate Report Wisconsin's* 2011 Best of Wisconsin Business Awards.

## CHECK OUT

Check out time is 12:00 noon. A luggage holding area is provided in our lobby for your convenience after check out. Complimentary laminated luggage tags are also available. Please contact the Front Desk for details.

## HOURS & TELEPHONE DIRECTORY

### Oros Dining Room Ext. 7101

Breakfast	7:00 am— 9:00 am	Monday through Friday
	7:00 am— 10:00 am	Saturday through Sunday
Lunch	11:30am— 1:30 pm	Monday through Friday

### Smitty's Study Pub Ext. 7816

4:30—11:00 pm daily, dinner served until 10:00 pm

\*vegetarian and gluten free options available upon request

### In-Room Dining Ext. 7816

4:30pm—10:00 pm, daily

### Business Center 2<sup>nd</sup> Floor

24 hour access with guest room keycard

### Fitness Center 1<sup>st</sup> Floor

5:00 am—11:00 pm, daily

### Front Desk Ext. 0

Available 24 hours

### Wisconsin School of Business Executive Education Offices Ext. 7357

8:00 am—5:00 pm, Monday through Friday

## TELEPHONE INSTRUCTIONS

### RECEIVING CALLS

Individuals who wish to call your room directly from outside the building may dial (608) 441-7 + your room number.

Information: 555-1212

Road Conditions: (800) 762-3947

Time & Temperature: 255-1234

Local calls and 800 calls are \$0.50 per call.

### DIALING INSTRUCTIONS

- Call within the building: Dial the four-digit extension
- Call from room to room: Dial 7 + room number
- Local calls: Dial 9 + the number.
- Long distance calls: Dial 9 + 1 + number
- International calls: Dial 9 + 011 + Country Code + City Code + number
- Operator-assisted calls, third-party calls, and collect calls: Dial 9 + 0 + number
- Please refer to the directory on your guestroom phone for additional dialing instructions

### WAKE UP CALL

You can arrange your wake-up call by dialing the Front Desk by dialing 0 or pushing the “Front Desk” direct dial button on your phone for assistance.

### MESSAGES

A light will flash on your phone when a message is waiting for you. Push the message button to retrieve your messages while on line 1 or dial 7555 and follow the prompts.



## GUEST CONVENIENCES

### ART GALLERY

Our art gallery which contains collections from local artists is located on the first floor next to our dining room and adjacent to the front desk. Come check out the beautiful photos and artwork we have on display!

### BUSINESS CENTER

Desktop computers and a combination fax machine/copier/printer are available in the Business Center located on the second floor. As well as basic office supplies you may need while using the Business Center. For printing or copying over 15 pages, please see the front desk.

### CHANNEL LIST

To find a television channel listing please press the menu button on your remote.

### FAXES

Faxes can be sent to the Front Desk at (608) 441-7133. The center does not charge for sending or receiving faxes. The Front Desk can also scan and email a document.

### FITNESS CENTER

The Fitness Center is available from 5:00 am to 11:00 pm and is located on the first floor. A variety of equipment is available, including a compact trainer, free weights, yoga mats, elliptical trainer, treadmills, a Stairmaster, and stationary bicycle. Towels are located in the Fitness Center, as well as daily newspapers and periodicals.

### GIFT SHOP

A selection of UW Madison gifts are available for purchase at the Front Desk.

### HOUSEKEEPING

All guest rooms receive daily housekeeping services. If you do not wish your room serviced, please display the "Privacy Please" sign on your door when you leave for the day.

### ICE & VENDING

Beverage and Ice machines are available on the 4<sup>th</sup> & 6<sup>th</sup> guest room floors located at the end of the each hallway. Snack and Ice machines are available on the 5<sup>th</sup> & 7<sup>th</sup> guest room floors.

### INTERNET ACCESS

The Fluno Center provides complimentary wireless throughout the building and in guest rooms. No log-in required. The network name is Fluno. If you prefer to connect directly, an Ethernet cable is available in your guest room desk drawer.

### LAUNDRY/DRY CLEANING

Laundry and dry cleaning services are available twice a week (1) pick up on Monday and returned on Thursday or (2) pick up on Thursday and returned on Monday. Items must be turned in by 7:00 am at the Front Desk. Laundry tickets and reusable Green Garmento dry cleaning bags are available in your room. The dry cleaning bags are also available for purchase.

## GUEST CONVENIENCES, CONTINUED

### MAIL SERVICES

When you receive mail, the message light on your room phone will flash. Feel free to pick up your mail at the Front Desk at any time. Outgoing U.S. mail can be dropped off at the Front Desk. UPS shipping is available through the front desk if you provide a UPS account number for shipping there is no additional charge.

Using the Fluno Center's UPS account number will involve a shipping and handling charge of \$8.00 in addition to the normal shipping charges.

USPS is available through the post office on Lake Street 441 N Lake Street

### MICROWAVES

Microwaves are available on request at the Front Desk for your guestroom. If you would like a microwave delivered to your room please contact the front desk.

### NEWSPAPERS AND PERIODICALS

A selection of local and national newspapers and periodicals are available in the lobby on the first floor.

Local magazines are provided in your room.

### PARKING

The parking lots available during your stay with us are run through UW Transportation. For any questions regarding parking, please contact the front desk or call the Parking Booth at (608) 263-8845 or Lot 83 at (608) 262-8683.

*Lot 83-Fluno Center (underground):* Enter from Frances Street, take ticket (bike racks inside the entrance to the right)

*Lot 46-Southeast Ramp:* Enter at corners of Frances and Johnson and Lake Streets, 10 hour meters at Frances Street entrance

### SAFETY DEPOSIT BOXES

For your convenience, safety deposit boxes are available for your use at the Front Desk at no charge.

### SMOKING

The Fluno Center is a non-smoking facility. You may smoke outside the building on the ground level.

### TOILETRY AMENITIES

Leave something behind when packing? The Front Desk has a variety of toiletry amenities to cater to your needs. Toiletries are available for your convenience at no charge. An ironing board, iron, and Madison phone directory can be found in your closet. An extra pillow is located your bottom dresser drawer.

## TRANSPORTATION

### TAXIS\*

Madison Taxi: (608) 255-TAXI (8294) / [www.madtaxi.com](http://www.madtaxi.com)

Green Cab of Madison: (608) 255-1234 / [www.greencabofmadison.com](http://www.greencabofmadison.com)

Union Cab of Madison Cooperative: (608) 242-2000 / [www.unioncab.coop](http://www.unioncab.coop)

Badger Cab: (608) 256-5566 / [www.badgercab.com](http://www.badgercab.com)

\*The Front Desk can order a cab for you for your convenience.

### METRO BUS SYSTEM

City of Madison Metro Transit: (608) 266-4466 (plan your route on Google Maps)

### LIMOUSINE

BJ's Limo Service: (608) 217-4494

Classic Limo and Motorcoach Inc.: 1-800-300-7595 / [www.classiclimoandbus.com](http://www.classiclimoandbus.com)

Gallant Knight Limousine: (608) 242-7000 / [www.gallantknightusa.com](http://www.gallantknightusa.com)

Limousine Connection Inc.: 1-800-754-9890

### HORSE CARRIAGE TOURS

Cobblestone Carriages: (608) 251-3030 / [www.cornerstonecarriagesllc.com](http://www.cornerstonecarriagesllc.com)

Take a pleasant horse-drawn carriage ride around the Capitol square and the beautiful downtown Madison area. Tours are given Fridays and Saturdays, May 1—September 30, from 6:00PM to midnight. Reservations are best!

### TO MILWAUKEE

The Badger Bus departs daily from the Memorial Union to the Depot in downtown Milwaukee. For schedule information call (608) 255-6771 or the Union at (608) 265-3000.

### TO CHICAGO

Van Galder Bus Line has daily departures from the 800 University Avenue, servicing the Chicago/O'Hare Airport, the Amtrak station, and the downtown Chicago area. For fare and schedule information call 1-800-747-0994 or contact the Fluno Center front desk at (608) 441-7117. [www.vangalderbus.com](http://www.vangalderbus.com)

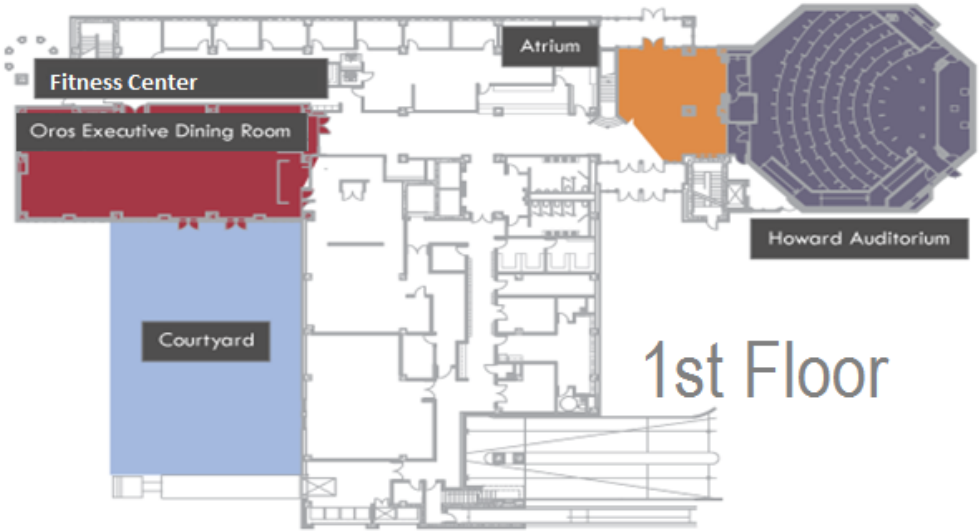

1st Floor

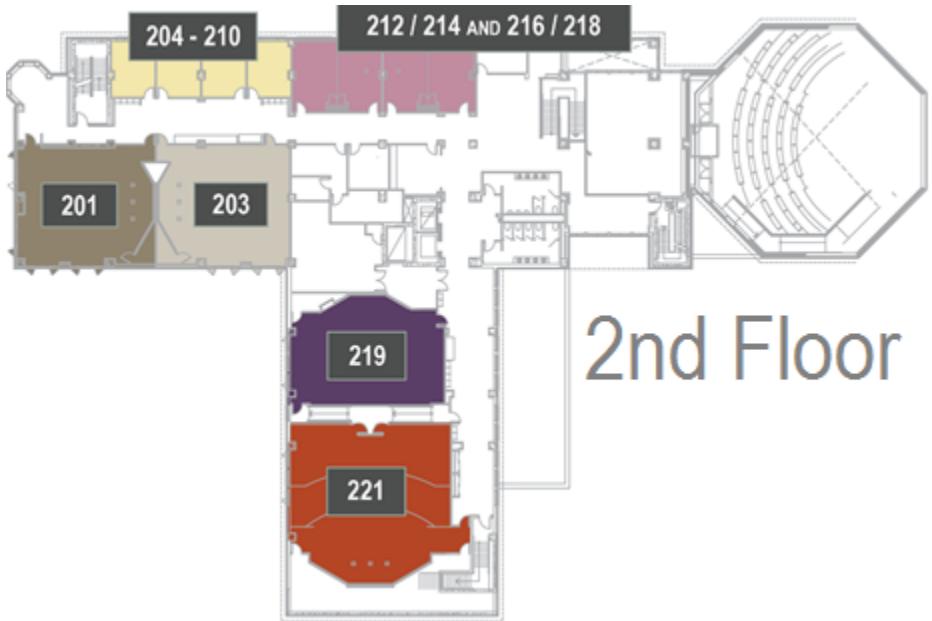

2nd Floor

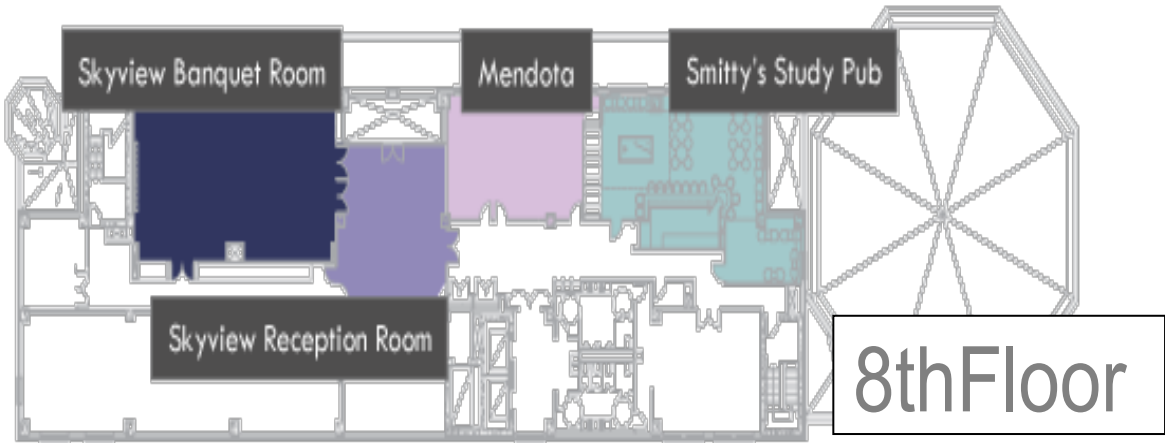

8th Floor

# EMERGENCY PROCEDURES

## EMERGENCY SIRENS AND LIGHTS

If the Fluno Center for Executive Education siren and lights are activated this means the fire alarm system has been initialized in the building. Everyone must leave the building immediately following evacuation signage on the back of the guest room door or in the meeting room.

## EXITS

The Center has stairwells on the East and West ends of the building that serve all eight floors. On the second floor there is an additional stairwell at the end of the South hallway, next to room 221, that leads out of the building.

## HOUSE PHONES

Throughout the Center there are black phones that may be used to call the Front Desk at any time of the day or night by pressing “0.”

## MEDICAL EMERGENCY

In the event of a medical emergency, please contact the Front Desk immediately by using a house phone and dialing “0.” If it is a very minor injury and only basic first aid is needed, you may call the Front Desk or stop at the Seminar Aide desk on the 2nd floor, or the Front Desk on the 1st floor, for assistance. To call the local fire or police department from any phone, dial “911.”

The Fluno Center for Executive Education has first aid kits and fire extinguishers located throughout the building. There is one Automated External Defibrillator (AED) located on the 1st floor next to the dining room. Fluno Center members are trained in First Aid, Adult CPR and in use of the AED. Upon notification of an emergency, our staff will take control of the situation by calling the Fire Department/EMTs or police as needed, bringing a first aid kit and AED to the injured person and providing basic care until professional help arrives.

## SEVERE WEATHER

The Fluno Center for Executive Education staff monitors the National Weather Service Emergency notification system at all times for weather-related watches and warnings. In the event of a weather related emergency that requires guests to move to a weather shelter, our staff will personally visit all meeting rooms and call all guest rooms to inform guests where to go for proper shelter. To monitor the weather forecast, tune the guest room television to Channel 65. To view local weather online, go to: [www.channel3000.com/weather](http://www.channel3000.com/weather).

## SAFETY TIPS

### *PREPARE*

Locate the fire exits, alarms, and extinguishers nearest your room and know how to turn off heating/air conditioning unit also, how to open and close windows. Know where your room key is at all times.

### *ACT*

If you are unsure whether or not there is a fire, notify the Front Desk. In case of a fire, touch your guest room door. If the door is hot, **DO NOT OPEN**. If you leave your room, take your room key and go to the nearest fire exit. Stay below any smoke that may be in the corridor. **DO NOT** use the elevators. All fire exit doors lead to stairwells. Enter the stairwell, close the door behind you and exit the building.

### *SURVIVE*

If you must return to or stay in your room, turn off the heating or air conditioning unit. Fill the bathtub completely with water. Wet sheets and stuff them completely around the door.

### *BLOCK VENTS EMITTING SMOKE*

Open windows only if you are sure fresh air is available and call the front desk by dialing 0 or use the direct dial button on your phone and give your room number or location. Keep a wet cloth over your nose and mouth. If the door and walls are hot, throw water on them with an ice bucket. Stay calm and do not panic.

### *IN OTHER CIRCUMSTANCES*

Whenever you are in a public area, observe the location of the fire exits. In case of fire or smoke, stay calm. Go to the nearest exit, stay beneath the level of smoke and exit the building.

## SPORTS & RECREATION

### Camp Randall

1440 Monroe Street

(608) 262-1866

<http://www.uwbadgers.com/facilities/camp-randall.html>

Camp Randall is a memorial athletic field, previously the training ground for more than 70,000 troops during the Civil War, and currently the home of Badger football and athletics.

### Kohl Center

601 West Dayton Street

(608) 263-5645

[www.uwbadgers.com/facilities/kohl-center.html](http://www.uwbadgers.com/facilities/kohl-center.html)

The home of Badger basketball and hockey, this state-of-the-art facility also is a venue for state tournaments, concerts, family shows, and university events. Drop-in tours are given Tuesday and Thursday at noon. Group tours by reservation.

### Memorial Union Outdoor Rentals

Hours are seasonal.

800 Langdon Street

(608) 262-7351

[www.union.wisc.edu/outdoorrentals.htm](http://www.union.wisc.edu/outdoorrentals.htm)

Rent canoes, kayaks, etc. for your outdoor enjoyment. You must have your conference badge for rental access.

### Natatorium

M-F 7:00 am—10:00 pm, Sat.

10:00 am—7:00 pm, Sun. 12 noon—7:00 pm

(Call for hours of specific activities)

2000 Observatory Drive

(608) 262-3742

[www.recsports.wisc.edu](http://www.recsports.wisc.edu)

Offers a variety of recreational activities such as racquetball, badminton, softball, basketball, volleyball, swimming, outdoor tennis, soccer, exercise room, weight room, and circuit training. *See guest policy above*

## SPORTS & RECREATION, CONTINUED

University Ridge Golf Course  
7120 County Trunk PD, Verona, WI  
(608) 845-7700  
[www.universityridge.com](http://www.universityridge.com)

Upscale, daily fee golf course designed by Robert Trent Jones II that challenges golfers of all levels.

Wisconsin Hoofers  
800 Langdon Street  
(608) 220-8240 (Program Coordinator)  
(608) 262-7445 (Boathouse)  
[www.hoofers.org](http://www.hoofers.org)

Hoofers offers three Conference Sailing packages including a day sail for experienced sailors (\$25/hr), sailing or windsurfing lessons (\$30), and a guided sail for those who want to sit back and enjoy the scenery (\$65 first hour, \$30 each additional hour).

For more sports and recreation options, please see the front desk.



## MEDICAL SERVICES

### MERITER HOSPITAL

202 South Park Street

24-hour Emergency Care: (608) 267-6206

General Information: (608) 267-6000

[www.meriter.com](http://www.meriter.com)

### ST.MARY'S HOSPITAL

707 South Mills Street

24-hour Emergency Care: (608) 258-6800

General Information: (608) 251-6100

[www.stmarysmadison.com](http://www.stmarysmadison.com)

### UW HOSPITAL

600 Highland Avenue

Emergency Care: (608) 262-2398

General Information: (608) 263-6400

[www.uwhealth.org](http://www.uwhealth.org)

## NEARBY DRUGSTORES

WALGREENS (Retail and Photo Only)

676 State Street; (608) 257-2556; [www.walgreens.com](http://www.walgreens.com)

WALGREENS (includes Pharmacy as well as Retail and Photo)

311 East Campus Mall; (608) 251-0042; [www.walgreens.com](http://www.walgreens.com)

COMMUNITY PHARMACY

341 State Street; (608) 251-3242; [www.communitypharmacy.coop](http://www.communitypharmacy.coop)

CVS (includes Pharmacy as well as Retail and Photo)

2 South Bedford Street; (608) 251-6047; [www.cvs.com](http://www.cvs.com)

## PLACES OF WORSHIP

### CHRISTIAN

BLACKHAWK EVANGELICAL CHURCH  
Majestic Theatre at 115 King Street  
(608) 238-0183  
[blackhawkchurch.org/Sunday/blackhawk-downtown](http://blackhawkchurch.org/Sunday/blackhawk-downtown)

CALVARY LUTHERAN CHAPEL  
701 State Street  
(608) 255-7214 / [calvarymadison.org](http://calvarymadison.org)

THE CHURCH OF JESUS CHRIST OF  
ATTER-DAY SAINTS  
4504 Regent Street  
238-1262

FIRST BAPTIST CHURCH  
518 North Franklin Street  
(608) 233-1880 / [firstbaptistmadison.org](http://firstbaptistmadison.org)

FIRST CONGREGATIONAL UNITED  
CHURCH OF CHRIST  
1609 University Avenue  
233-9751 / [firstcongmadison.org](http://firstcongmadison.org)

GRACE EPISCOPAL CHURCH  
116 West Washington Avenue  
255-5147 / [graceec.org](http://graceec.org)

HOLY REDEEMER ROMAN CATHOLIC  
CHURCH  
144 W Johnson Street  
(608) 257-5000

THE JOURNEY COMMUNITY OF FAITH  
330 West Mifflin Street  
469-4741 / [thejourneycommunity.com](http://thejourneycommunity.com)

MADISON CHINESE CHRISTIAN CHURCH  
1510 Madison Street  
251-2251 / [madisonccc.org](http://madisonccc.org)

ST. FRANCIS HOUSE  
1001 University Avenue  
(608) 257-0688 / [stfrancisuw.org](http://stfrancisuw.org)

ST. PAUL'S UNIVERSITY CATHOLIC  
CENTER  
723 State Street  
(608) 258-3140 / [uwcatholic.org](http://uwcatholic.org)

ST. PAUL'S AFRICAN METHODIST  
EPISCOPAL CHURCH  
4525 Diamond Drive  
242-9728

UNIVERSITY UNITED METHODIST  
CHURCH  
1127 University Avenue  
(608) 256-2353 / [uumchurch.org](http://uumchurch.org)

WISCONSIN LUTHERAN CHAPEL  
220 West Gilman Street  
(608) 257-1969 / [wlchapel.org](http://wlchapel.org)

### JEWISH

BETH ISRAEL CENTER  
1406 Mound Street  
256-7763 / [bethisraelcenter.org](http://bethisraelcenter.org)

CHABAD OF MADISON  
1722 Regent Street  
231-3450 / [chabaduw.com](http://chabaduw.com)

### MUSLIM

ISLAMIC COMMUNITY OF MADISON  
21 North Orchard Street  
251-9851 / [islamiccentermadison.org](http://islamiccentermadison.org)

MADINAH COMMUNITY CENTER  
4718 Hammersley Road  
313-4718 / [madisonmuslims.org](http://madisonmuslims.org)

## RESTAURANT QUICK LIST

### BREAKFAST

<b>Sunroom Café</b>	638 State St (608) 255-1555	<b>Hours:</b> Mon-Thurs 7am-9:30pm Fri-Sat 7am-10pm, Sun 9am-9pm
<b>Bassett Street Brunch Club</b>	444 West Johnson St. (608) 467-5051	<b>Hours:</b> Mon-Wed 7 am-10pm, Thur-Fri 7am-12am, Sat 8am-12am,
<b>Marigold Kitchen</b>	118 South Pinckney St (608) 661-5559	<b>Hours:</b> Weekdays 7am-3pm Sat 7am-2pm, Sun 8am-2pm

### GLOBAL OPTIONS

<b>L'Etoile</b>	1 S Pinckney St. #107 (608) 251-0500	<b>Hours:</b> Mon-Thurs 5:30pm Fri-Sat opens at 5:00pm
<b>Eno Veno</b>	1 N. Webster St, 10 <sup>th</sup> Floor (608) 455-0663	<b>Hours:</b> Mon-Fri 4pm-12am Sat-Sun 4pm-1am
<b>Estrellon</b>	313 W Johnson St (608) 251-2111	<b>Hours:</b> Sun, Tues-Wed 5pm-10pm Fri-Sat 5p-11p
<b>Brocach</b>	7 West Main St. (608) 255-2015	<b>Hours:</b> Weekdays 11am-Bar Close Weekends 10am-Bar Close
<b>Tutto Pasta</b>	305 State St. (608) 294-1000	<b>Hours:</b> Sun-Thurs 11am-9pm, Fri-Sat 11am-10pm
<b>Coopers Tavern</b>	20 W Mifflin St (608) 256-1600	<b>Hours:</b> Weekdays 11am-Bar Close Weekends 9am-Bar Close

### PUB

<b>Old Fashioned</b>	23 N Pickney St #1 (608) 310-4545	<b>Hours:</b> Mon-Tue 7:30am-10:30pm, Wed-Fri 7:30am-2am, Sat 9am-2:30am Sunday 10am-2am
<b>Great Dane</b>	123 Doty St #1 (608) 284-0000	<b>Hours:</b> Mon-Thurs 11am-2am, Fri 11am-2:30am, Sat 10am-2:30am Sunday 10am-2am
<b>Dotty Dumplings</b>	317 N Frances St (608)259-0000	<b>Hours:</b> Mon-Wed 11am-11pm, Thurs-Sat 11am-1am, Sun 12pm-10pm

### STEAK

<b>Tornado Steak</b>	116 S Hamilton St	<b>Hours:</b> Open daily 5:30pm-10pm
<b>Delmonico's</b>	130 S Pinckney St	<b>Hours:</b> Fri-Sat 5pm-10pm.

\*\*See front desk for further delivery and restaurant dining options/recommendations.

## ATMS

### MARKET FRESH ATM

703 University Ave  
(608) 287-0000  
<http://freshmadisonmarket.com>

### CHASE ATM

519 State Street  
(800) 935-9935  
[chase.com](http://chase.com)

### UW CREDIT UNION

662 State Street  
(608) 232-5000  
[uwcu.org](http://uwcu.org)

### WELLS FARGO ATM

505 University Avenue  
(800) 869-3557  
[wellsfargo.com](http://wellsfargo.com)

## DELIVERY DINING

ROOM SERVICE (with menu)  
Available 5:00—10:00 pm, daily

### MR. DELIVERY

[www.mrdelivery.com](http://www.mrdelivery.com)

### GrubHub

[www.grubhub.com](http://www.grubhub.com)

## MALL INFORMATION

### WEST TOWNE MALL

66 West Towne Mall  
(608) 833-6330  
Hours: Mon-Sat 10am-9pm, Sun 11am-6pm

### EAST TOWNE MALL

89 East Towne Mall  
(608) 244-1387  
Hours: Mon-Sat 10am-9pm, Sun 11am-6pm

### HILDALE

702 N Midvale Blvd.  
(608) 238-6640  
Hours: Mon-Sat 10am-9pm, Sun 11am-6pm

## MOVIE THEATRES

### POINT CINEMA

7825 Big Sky Drive  
(608) 242-2100

### EASTGATE CINEMA

2830 Hoepker Rd  
(608) 242-2100

### AMC STAR

6091 Mckee Road  
(608) 270-9036

### MARKET SQUARE 5

6604 Odana Road  
(608) 833-1500

### Sundance Cinema

430 N Midvale Blvd  
(608) 316-6900

## HAIR SALONS

### BACI HAIR SALON

1719 Monroe St.  
(608) 255-0775

### ELEVATION SALON AND SPA ( nail services)

15 N Butler Street  
(608) 661-3636

### HAIR

1839 Monroe St.  
(608) 259-1111

### HAIR FORUM

606 University Ave  
(608) 255-1930

### STADIUM BARBERS

1515 Monroe Street  
(608) 255-1588

### TEXTURE (offers nail services)

2501 W Beltline Hwy Suite 109  
(608) 441-8640

### WAYNE'S BARBER SHOP

420 S Park Street  
(608) 256-1623

# ENVIRONMENTAL STEWARDSHIP

## A SUSTAINABLE FUTURE

The Fluno Center for Executive Education has a deep respect for preservation of the environment and doing our part to provide a sustainable future. We are committed to promoting environmental stewardship by embracing sustainable practices that are environmentally sound, socially responsible, and economically viable.

Throughout our operations, we develop and implement programs and policies within the areas of sustainable food, responsible procurement, green buildings, energy and water conservation, transportation, and waste stream management.

## OUR ENVIRONMENTAL INITIATIVES

- \* “Green” Hotels Association Member
- \* Recycling used guest room soap in partnership with the non-profit organization, Clean the World
- \* Eco-friendly dry cleaning bag program
- \* Utilizing Green Seal® certified cleaning products where possible
- \* Paperless check-in
- \* In-room recycling
- \* Guest Room Linen Washing Reduction Program
- \* Seafood Aligned with the Monterey Bay Seafood Watch Program
- \* Recycling 100% of our fryer oil waste
- \* Energy conservation in our daily operations
- \* Off-hours lighting reduction in non-use areas
- \* Off-hours HVAC reduction in maintenance support areas
- \* Compact fluorescent lighting (CFL) installed where possible
- \* Sustainability Action Committee to continually evaluate stewardship